

- 1 Pump connection (P)
- 2 Tank connection (T)
- 3 Cylinder connection SAE (C)
- 4 Pneumatic connection (Tip) 6 mm
- 5 Pneumatic connection (Lower) 6 mm
- 6 Pressure relief cartridge
- 7 Pressure gauge point (MPC)
- 8 Adjustment screw (To adjust the lowering speed)

SAFETY:

HT valve fitted on cylinder (SAE) port offers hose burst safety function

3D model is available on request

Types

| Hydraulic connections | Pressure (BAR) | | Part Number | Description |
|----------------------------|----------------|------|-------------|---------------------------------|
| | | Max. | | |
| P: 3/4" T: 1" C: SAE | | 135 | 14767452 | TIP VALVE HT-SAE-1220-135-P3/4" |
| | | 150 | 14767454 | TIP VALVE HT-SAE-1220-150-P3/4" |
| | | 170 | 14767456 | TIP VALVE HT-SAE-1220-170-P3/4" |
| | | 190 | 14767458 | TIP VALVE HT-SAE-1220-190-P3/4" |
| | | 220 | 14767460 | TIP VALVE HT-SAE-1220-220-P3/4" |
| | | 250 | 14767462 | TIP VALVE HT-SAE-1220-250-P3/4" |
| T & P: 1" C: SAE | | 135 | 14767453 | TIP VALVE HT-SAE-1220-135-P1" |
| | | 150 | 14767455 | TIP VALVE HT-SAE-1220-150-P1" |
| | | 170 | 14767457 | TIP VALVE HT-SAE-1220-170-P1" |
| | | 190 | 14767459 | TIP VALVE HT-SAE-1220-190-P1" |
| | | 220 | 14767461 | TIP VALVE HT-SAE-1220-220-P1" |
| | | 250 | 14767463 | TIP VALVE HT-SAE-1220-250-P1" |

| Optional adapter kits | Kit number |
|-----------------------|------------|
| 3/4" Straight SAE | AK5112SS |
| 3/4" 90 degree SAE | AK5112SE |
| 1" Straight SAE | AK5116SS |
| 1" 90 degree SAE | AK5116SE |

| Mounting kits | Kit number |
|-----------------|------------|
| Cylinder (SAE)* | 14735175 |

* included with valve

Specifications

| | | |
|-------------------------------|---|------------------------------|
| Type | 3/3 pneumatic operated tipping valve with proportional lowering | |
| Max. peak pressure | 350 bar | |
| Pneumatic pilot pressure | 6 - 12 bar | |
| Max. pump flow | 220 L/min | |
| Max. pressure on T-connection | 10 bar | |
| Filtration (ISO 18/13) | ≤ 25 µm | |
| Viscosity range | min | 12 mm ² /s (cSt) |
| | max | 100 mm ² /s (cSt) |
| Temperature range | min | -40 °C |
| | max | 80 °C |
| Mass | 5,5 kg | |

Δp - Q characteristic

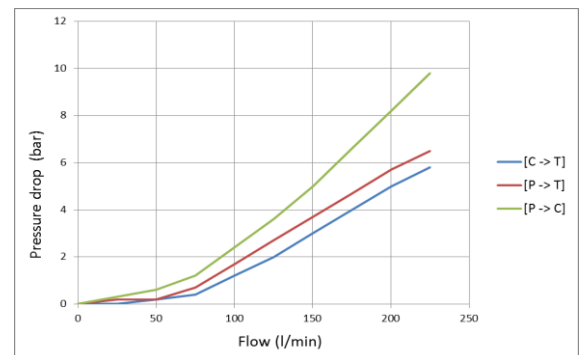

Technical notes

- Mount the valve according the mounting instructions • Use the correct washers and adapters in the ports to prevent deformation of the housing. Do not use adapters with tapered threads • To further prevent deformation of the valve housing, the mounting plate surface or block must be completely flat and smooth
- Do not weld to the valve • Ideal air pressure for valve is 8 bar • Make sure inlet air is dry • Paint spec: TN00_00001

Related documentation

Mounting instructions: VAL-0021

OIL Specifications: OIL-0011

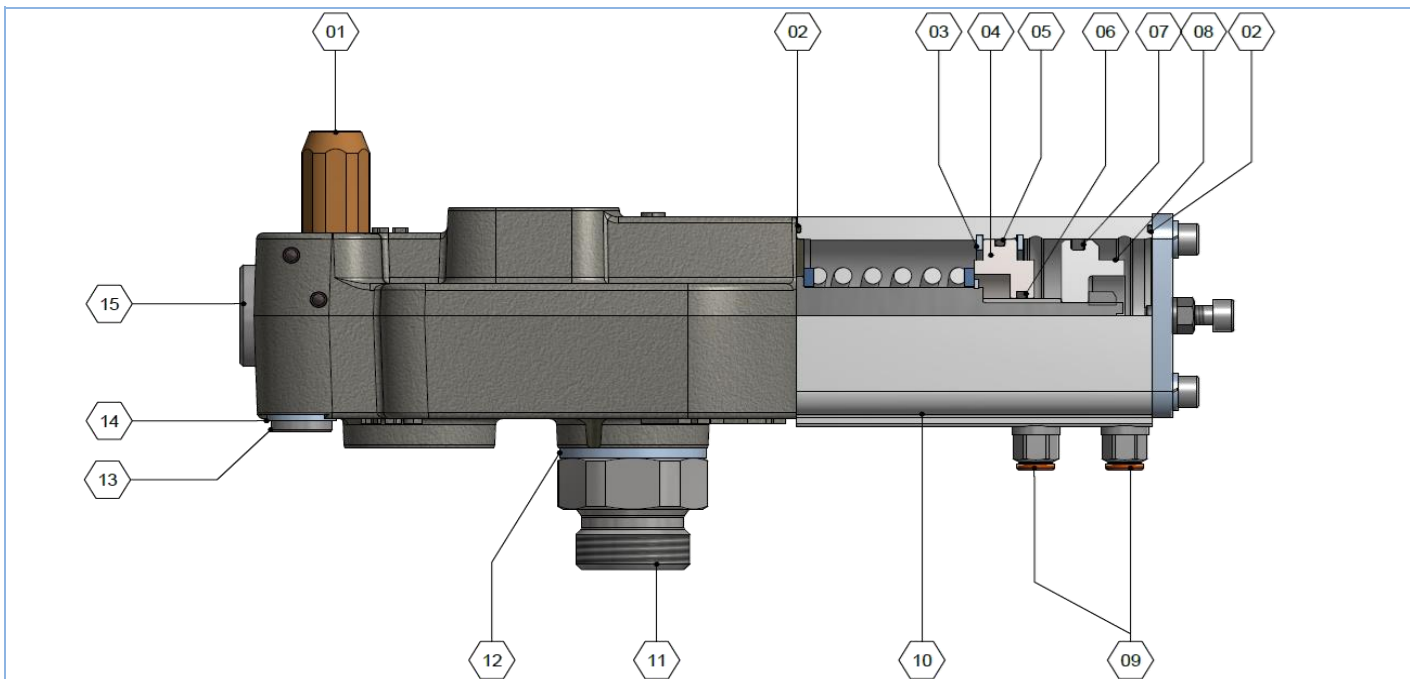

Spare Parts

| No. | Part no. | Description | Qty. |
|-----|---------------------|---------------------------|------|
| 1 | 14772__ | Pressure relief cartridge | 1 |
| | 135 | 135 bar | |
| | 150 | 150 bar | |
| | 170 | 170 bar | |
| | 190 | 190 bar | |
| | 220 | 220 bar | |
| | 250 | 250 bar | |
| 2 | n.a; see repair kit | O-ring | 2 |
| 3 | n.a; see repair kit | Circlip | 2 |
| 4 | n.a; see repair kit | Closing plate | 1 |
| 5 | n.a; see repair kit | O-ring | 1 |
| 6 | n.a; see repair kit | Quadring | 1 |
| 7 | n.a; see repair kit | Quadring | 1 |

| No. | Part no. | Description | Qty. |
|-----|---------------------|-----------------------|------|
| 8 | n.a. | Piston air cylinder | 1 |
| 9 | 14810517 | Air coupling 6 mm | 2 |
| 10 | n.a; see repair kit | Aluminium head | 1 |
| 11 | 14739980 | Non-return valve 3/4" | 1 |
| 11 | 14739975A | Non-return valve 1" | 1 |
| 12 | 01313848 | Bonded seal 1" | 1 |
| 13 | n.a. | Plug 1/4" | 1 |
| 14 | 01206813 | Bonded seal 1/4" | 1 |
| 15 | n.a. | Plug M27 | 1 |

Repair kits

| | | |
|--|----------|--|
| | 14844010 | Seal kit (contains pos. 2, 5, 6, 7) |
| | 14845003 | Air cylinder kit (contains pos. 3, 4, 5, 6, 10) |

Hydraulic symbol HT valve

